

DORSET COUNTY COUNCIL

APPLICATION FORM FOR A MODIFICATION TO
THE COUNTY OF DORSET DEFINITIVE MAP AND STATEMENT OF RIGHTS OF WAY
Wildlife and Countryside Act 1981

To: Chief Executive
Dorset County Council
County Hall
Colliton Park
DORCHESTER
Dorset
DT1 1XJ

I/We (i) MR B T O'DRISCOLL

of (ii) 182A WESTBAY ROAD, BRIDPORT, DORSET

hereby apply for an order under Section 53(2) of the Wildlife and Countryside Act 1981 modifying the Definitive Map and Statement for the area by *- see attached Note

(a) Deleting the footpath / bridleway / byway open to all traffic * which runs
from: THE KISSING GATE [SY46569096] running North Easterly to the PRIVATE ACCESS
to: ROAD [SY46589100] and then Easterly to WESTBAY ROAD [SY46629100]

(b) Adding the footpath / bridleway / byway open to all traffic * which runs
from: THE KISSING GATE [SY46569096]
to: THE PRIVATE ACCESS ROAD at [SY46579102] where it joins FOOTPATH 22

(c) ~~Upgrading/downgrading to a footpath / bridleway / byway open to all traffic * the footpath/bridleway/byway open to all traffic which runs~~
from: _____
to: _____

(d) ~~Varying/adding to the particulars relating to the footpath / bridleway / byway open to all traffic *~~
from: _____
to: _____
by providing that _____

and shown on the map annexed hereto (see overleaf).

I/We attach copies of the following documentary evidence [including statements of witnesses] in support of this application:-

(iii) Material in support of this application has previously been supplied to the County Council and includes evidence of a legal Dimension Order made in 1935.

Also attached (1) Map with Grid Refs
(2) Schedule of Public Rights of Way (Parish Survey)
(3) Map showing footpaths referred to in schedule above
(4) Note re application Date: 20 June 2004

SIGNATURE REMOVED

Signed:

(i) Insert name of applicant(s)
(ii) Insert address of applicant(s)

(iii) Insert list of documents
* Delete as appropriate

DORSET COUNTY COUNCIL

CERTIFICATE OF SERVICE OF NOTICE OF APPLICATION FOR MODIFICATION ORDER

THE COUNTY OF DORSET DEFINITIVE MAP AND STATEMENT OF RIGHTS OF WAY

Wildlife and Countryside Act 1981

To: Chief Executive
Dorset County Council
County Hall
Colliton Park
DORCHESTER
Dorset
DT1 1XJ

I/We(i) MR B T O DRISCOLL

of (ii) 102 A West Bay Road, Bridport, Dorset.

hereby certify that the requirements of paragraph 2 of Schedule 14 to the Wildlife and Countryside Act 1981 have been complied with in relation to the attached application.

Signed: SIGNATURE REMOVED Date: 20 June 2004.

NOTES FOR GUIDANCE

This certificate should only be completed when notice of the application has been served on all owners and occupiers affected by the proposal. A list of the names and addresses of all individuals notified should be provided below. Please indicate if you have been unable to identify all owners and occupiers of any land to which the application relates.

Notice of Application Sent To:

	Name	Address
1.	<u>Mr & Mrs Joy</u>	<u>190 West Bay Road, Bridport, Dorset DT6 4EG</u>
2.	<u>Melplash Agricultural Society</u>	<u>23 South Street, Bridport, Dorset. DT6 3NT.</u>
3.	_____	_____
4.	_____	_____
5.	_____	_____
6.	_____	_____

(i) Insert name of applicant(s)

(ii) Insert address of applicant(s)

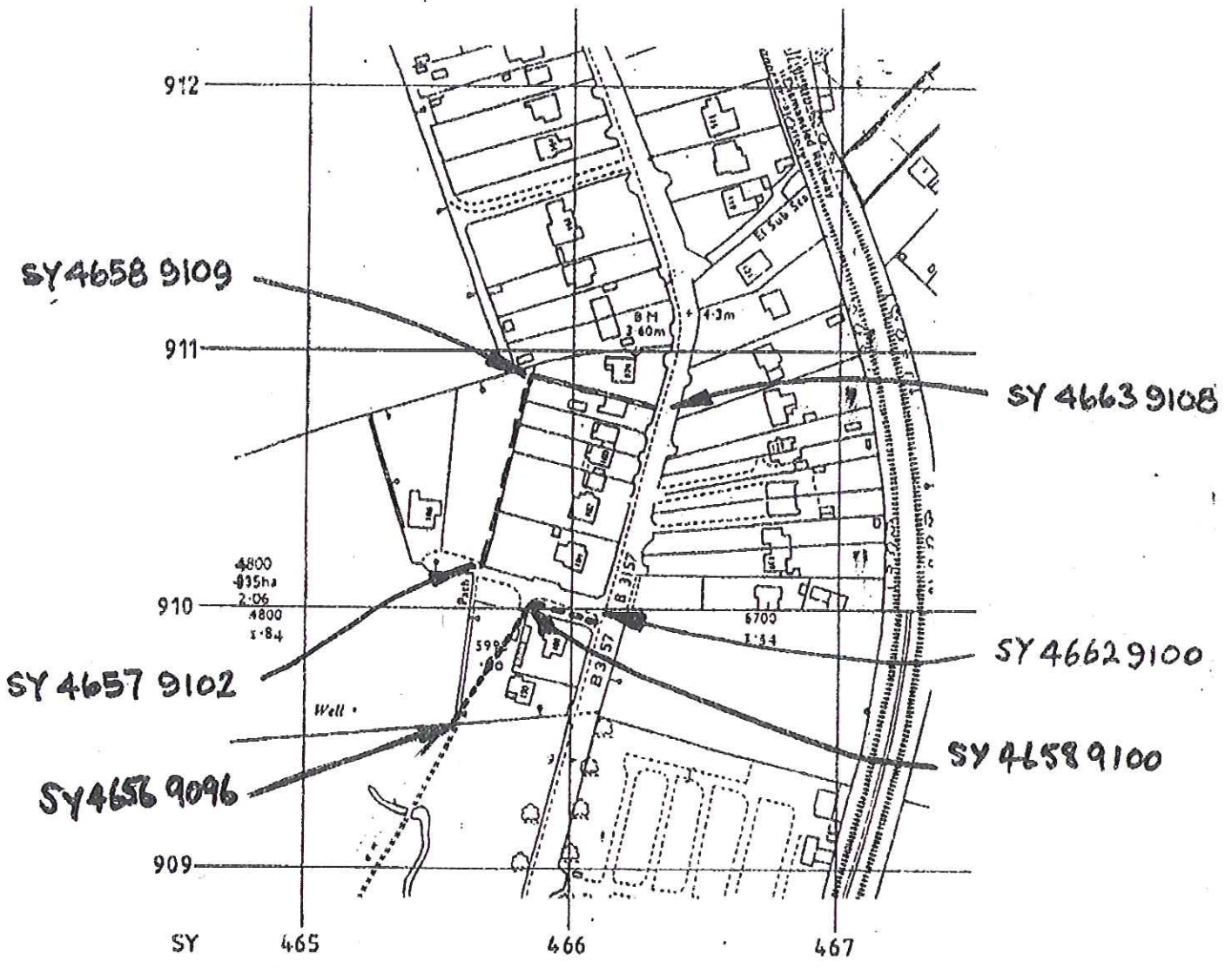

Scale: 1:2500

© Crown copyright. All rights reserved.
Licence number AR 100007164

BRIDPORT C P

NATIONAL PARKS AND ACCESS TO THE COUNTRYSIDE ACT 1949.Schedule of Public Rights of Ways in the Bridport Borough.

F

No. on
Plan

1. Commences at entrance to Camp Field with a 12' wide tarmac road for a length of approx. 420'. It is then followed by a rubble road for approx. 360' when it becomes an ordinary grass footpath up to the small stream which is crossed by a wooden plank bridge. The path continues for an approx. length of 218' when it runs alongside the river for 100' to a wooden stile which is the limit of the Borough Boundary. From there it continues through the R.D.C. area to the Borough Playing Fields which are situated in the R.D.C. and connects with Priory Lane.
2. Commences at the Western end of the Camp Field road and runs along whole Western border of Camp Field to wooden stile (as in No. 1) at the limit of the Borough Boundary. Well defined.
3. Path runs along tarmac road commencing at a point at the Camp Field entrance and running to the Borough boundary at the N. Western end of the Camp Field into West Cliff Estate in the R.D.C.
4. Commences at 3 concrete steps going up from East Beach thence over wooden stile for distance of approx. 100' to Borough boundary. Well defined and then into R.D.C. area of Burton Bradstock on to East Cliff.
5. Commences at iron kissing gate near "Riverside Cafe" across field to 2nd I.K. gate and then across second field to 3rd I.K. gate. At this point the path becomes fenced on either side and runs behind "Rockwater" and "Rosebay" for a distance of approx. 195'. It then crosses a 12' private road and runs along the rear of "Green Turrets", "Kelwyn" and "Invicta" for approx. 246' and then runs along the side of "Invicta" to iron kissing gate with access on to West Bay Road. Well defined.
6. Commences at a point between "Seacliffe" and "Basra" West Bay Road. Through wooden gate to 3' path for approx. 183' to railway line, and for a further 102' it runs alongside the railway line to a wooden stile then over railway line to connect to No's. 7 and 8.
7. Commences at wooden stile on Eastern side of railway line and ends at Burton Road opening between "Wyencroft" and "White Gates".
8. Commences at same point as No. 7 and runs alongside railway line for approx. 540' to a wooden fence and stile situated at the East end of Burton Road railway bridge. Path not clearly defined and does not appear to be greatly used.
9. Commences by "Wanderwell" under railway bridge. Entrance through wooden wicket gate to ~~the~~ path for a length of approx. 120' to Borough Boundary. Path well defined throughout. From Borough Boundary it runs through R.D.C. parish of Bothenhampton to Bothenhampton road near "Barn Corner".
10. Commences at junction of Priory Lane and Playing Fields Lane. Entrance from lane through iron wicket gate. Path approx. 2' wide throughout length and is bounded on either side by allotment gardens. Path is in the nature of a Cul-de-sac as there is no present access to either South Street or the Castle Square properties.
At its ending it gives the appearance of continuing through into

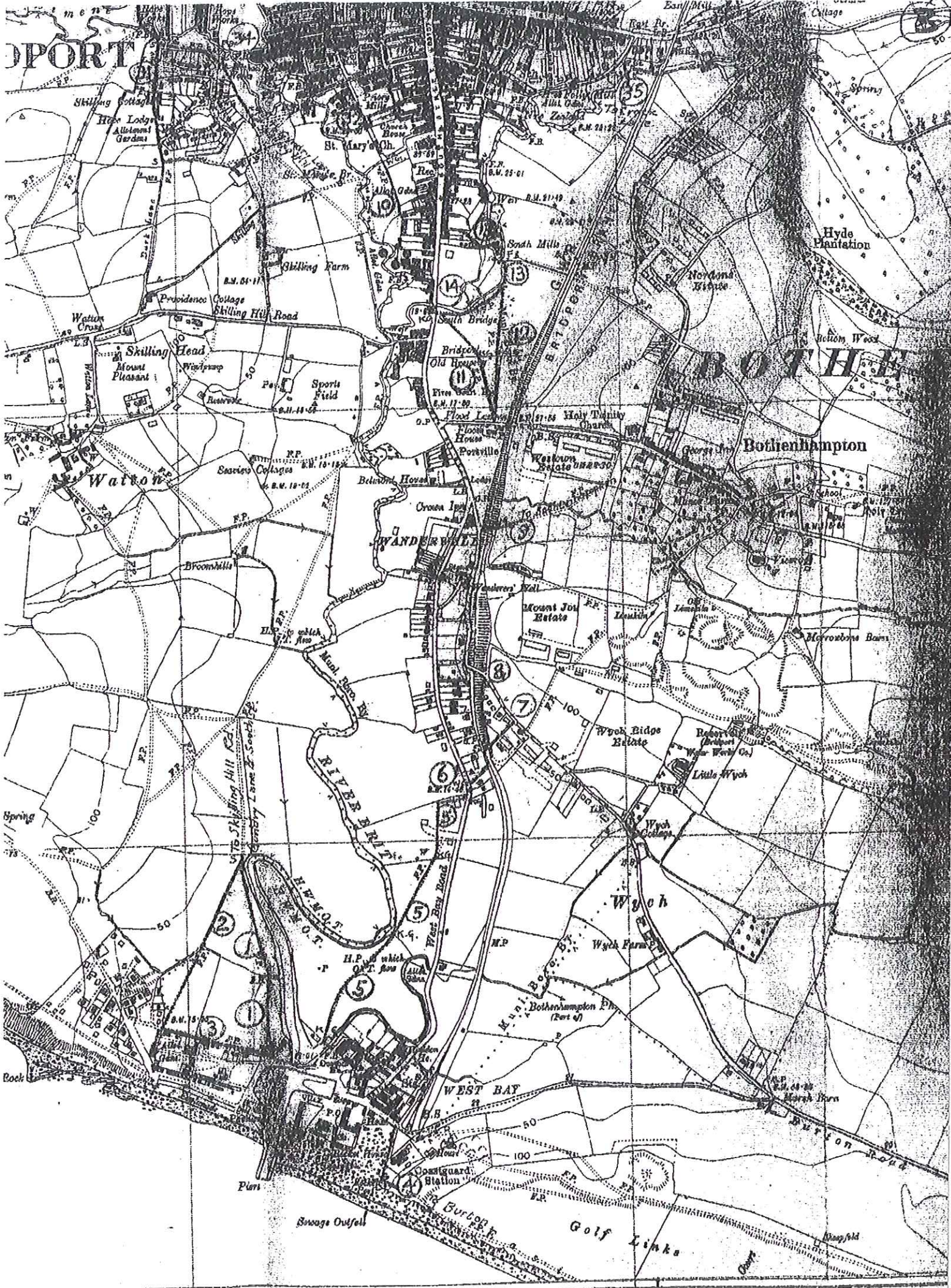

Application for a Modification to the County of Dorset Definitive Map and Statement of Rights of Way

Note regarding Public Footpath at West Bay Road
(To accompany Form A)

The Public Footpath shown on the attached map is described at item 5 on the "Schedule of Public Rights of Ways in the Bridport Borough" prepared at the time of the parish Survey undertaken under the National Parks and Access to Countryside Act 1949. (See copy extract from schedule supplied by Mr Philip Drake (Rights of Way) Dorset County Council)

The footpath, described in detail on the schedule, is not correctly drawn on the Definitive Map. (Mr Stephen Foreshaw, Archivist at the Dorset County Records Office confirmed that it appeared that a "human error" had occurred)

The attached application is made in order that this error may be corrected on the County of Dorset Definitive Map of Rights of Way.

Signed SIGNATURE REMOVED

Date 20 June 2004